

MERIDEN

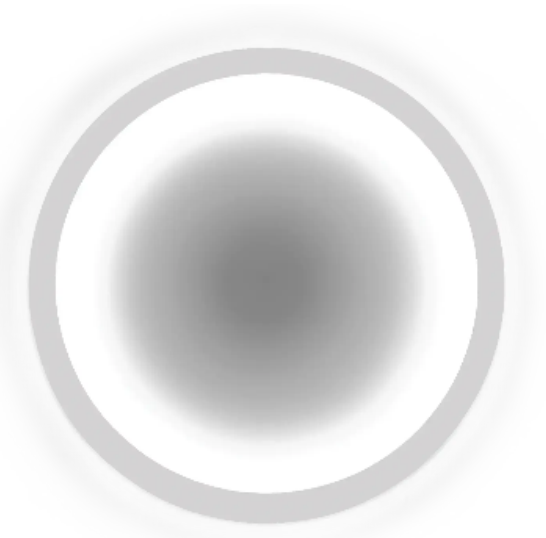

- IP40
- IK09
- 6 YEAR WARRANTY
- 4.0 KG
- 230v
- DALI
- NM/MM

LED CHARACTERISTICS	
CRI	80+
COLOUR TEMPERATURE	4000K
RATED LIFE (HOURS)	90K - L80/B10
PROTECTION	LUX GUARD
DRIVER EFFICIENCY	>80%
REPLACEABLE	YES
POWER FACTOR	>0.90
LL/CW	142.4



- EN 60598-1
- EN60598-2-22
- EN55015
- EN61547
- EN61000-3-2

EXAMPLE PRODUCT CODE		MER	XTA	1665	W
PRODUCT	MERIDEN	MER			
CONTROL	FIXED OUTPUT/ CENTRAL BATTERY	LA			
	FIXED OUTPUT/ CENTRAL BATTERY DALI	DA			
	3 HOUR MAINTAINED	LM			
	3 HOUR DALI MAINTAINED DIMMABLE	DL			
	3 HOUR MAINTAINED WITH SPECTO-XT	XT			
	3 HOUR MAINTAINED WITH SPECTO-XT PIR	XTA			
	CENTRAL BATTERY WITH SPECTO-XT PIR	MXTA			
LED	10W, 1665 LUMENS (2.2KG)	1665			
	17W, 2705 LUMENS (2.2KG)	2705			
	24W, 3685 LUMENS (2.2KG)	3685			
COLOUR	WHITE (RAL 9016)	W			

MERXTA1665 Meriden | 3 Hour Maintained With Specto-XT PIR | 10W, 1665 LUMENS
 This product contains a light source of energy efficiency class A.

MERIDEN



- IP40 IK09
- 6 YEAR WARRANTY 4.0 KG
- 230v DALI
- NM/MM



- EN 60598-1
- EN60598-2-22
- EN55015
- EN61547
- EN61000-3-2

POLAR CURVE

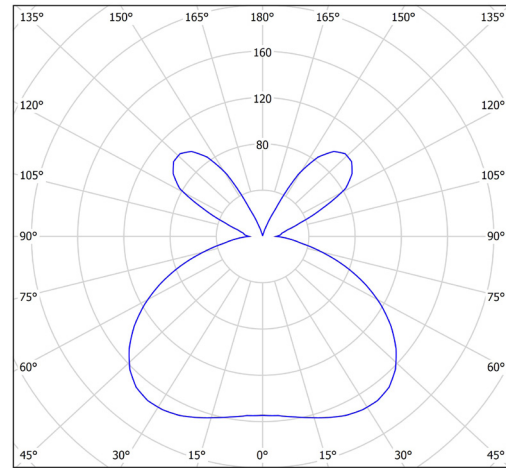

LUMINAIRE LUMEN OUTPUT

10W = 1665lm
17W = 2705lm
24W = 3685lm
Emergency = 340lm

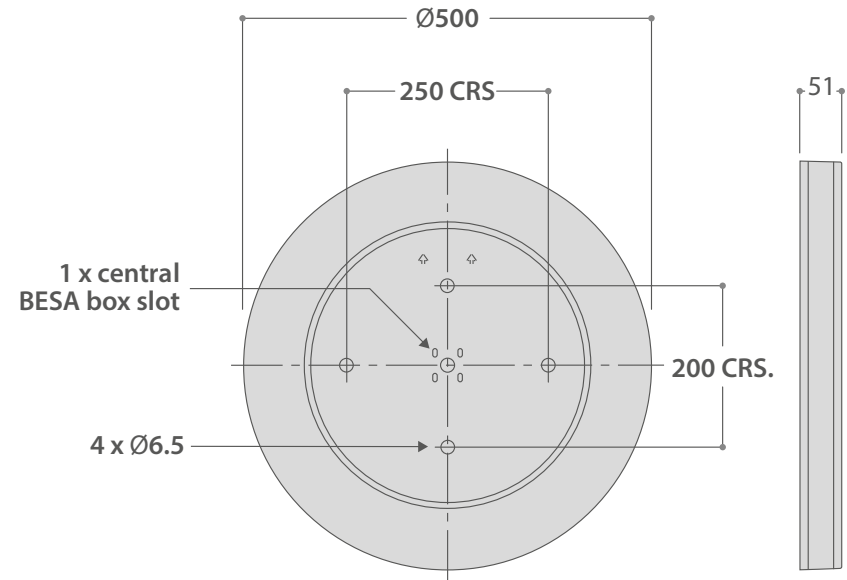

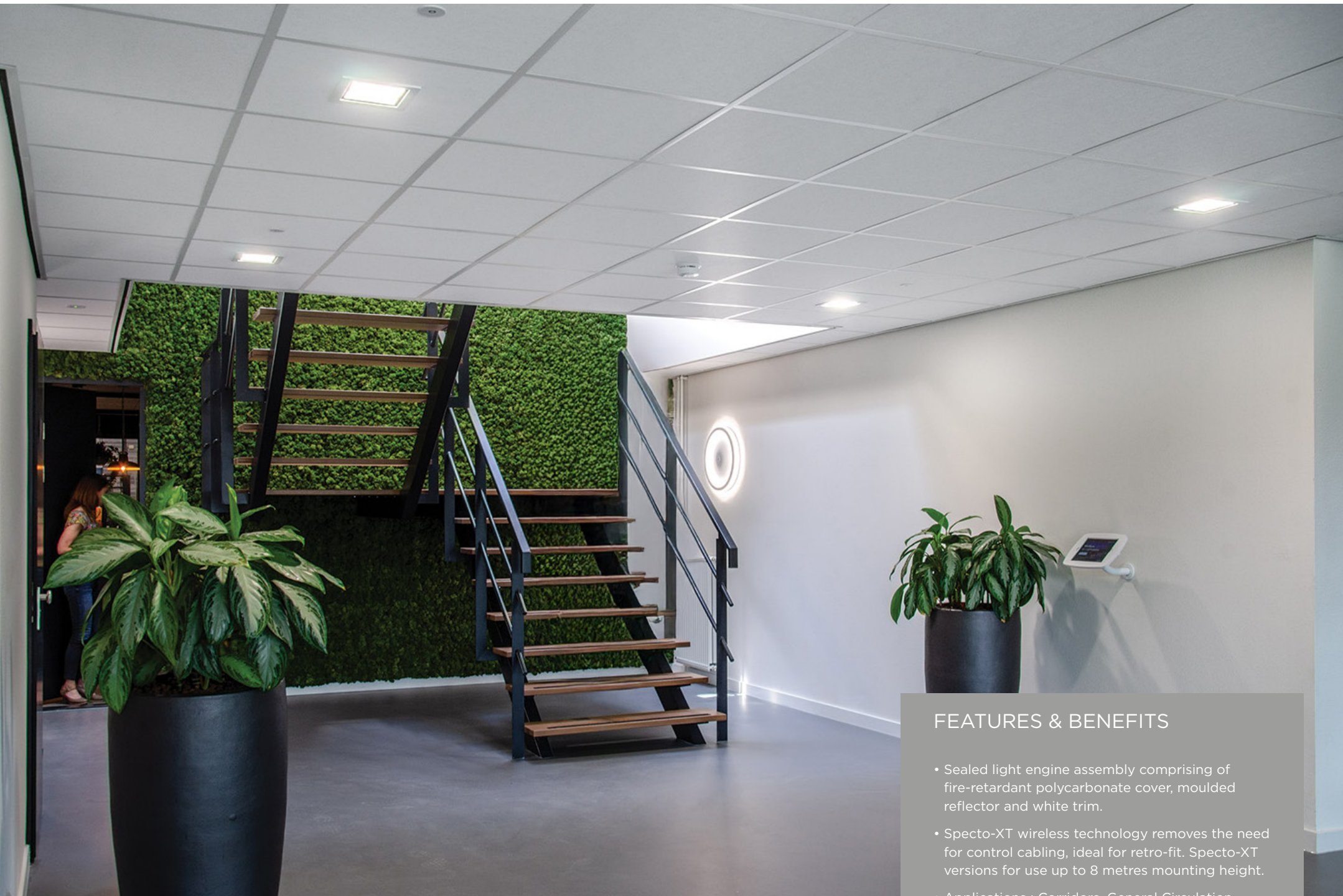

FEATURES & BENEFITS

- Sealed light engine assembly comprising of fire-retardant polycarbonate cover, moulded reflector and white trim.
- Specto-XT wireless technology removes the need for control cabling, ideal for retro-fit. Specto-XT versions for use up to 8 metres mounting height.
- Applications : Corridors, General Circulation Areas, Staircases, Bedrooms, Toilet areas.