

2000_RL



IP20

KG

1.0

230V
AC



- EN 60598-1
- EN55015
- EN61547
- EN61000-3-2

SURFACE

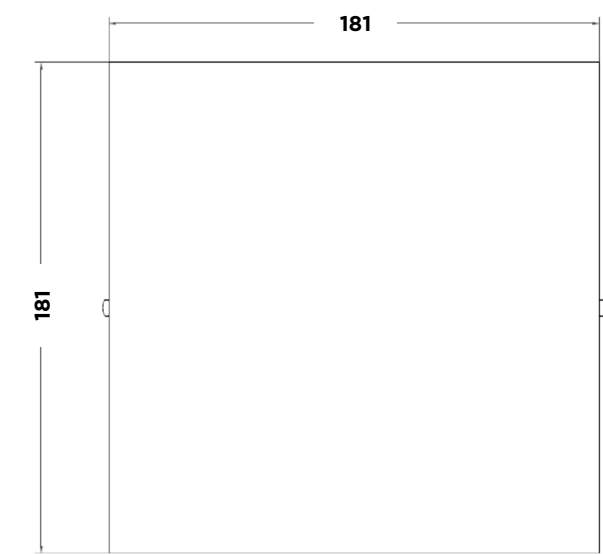

CABLE ENTRY BOTH SIDES

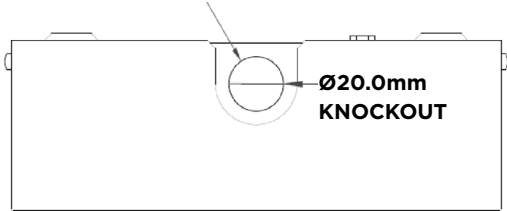

FLUSH

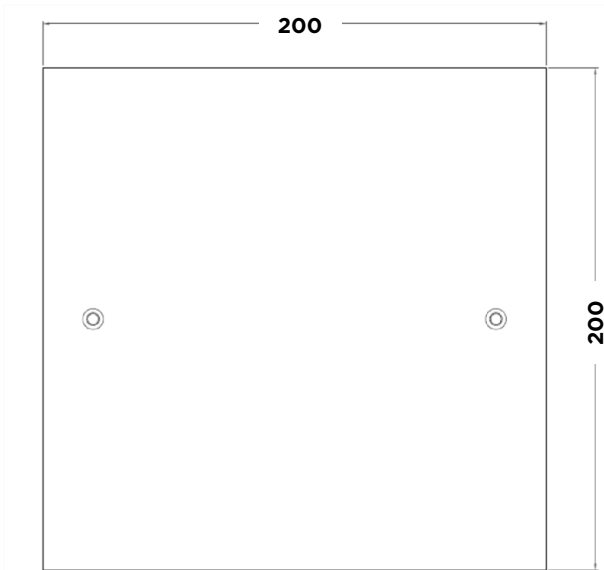

CABLE ENTRY BOTH SIDES

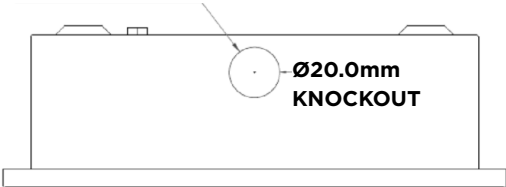

EXAMPLE PRODUCT CODE			2000	SRL
FAMILY	2000 RANGE, DELAY OFF TIMER	2000		
MOUNT	SURFACE	SRL		
	FLUSH	FRL		

Example Code 2000SRL 2000 Range, Delay Off Timer | Surface Mount
RAL 9016 as standard finish. For more information on colours, please go to the **Finishes Page**.
For use with two section hospital signage. Factory set to 2 second delay time.