

FEATURES

Model	Nordic Aluminium Track Adaptor	For Use With Nordic Aluminium Track Type	Downlighter Lens features	Supply voltage	Maximum luminaires on a Type B, 10A circuit breaker	Part No.
Non-Maintained	GA69	GLOBAL TRAC PRO	Open Area	220-240V AC 50/60 Hz	90 Luminaires	SPTA860LN SPTA870LN
			Standard	220-240V AC 50/60 Hz	90 Luminaires	SPTE860LN SPTE870LN
DALI	GAC69	GLOBAL TRAC PULSE	Open Area	220-240V AC 50/60 Hz	90 Luminaires	SPTA860DS SPTA870DS
			Standard	220-240V AC 50/60 Hz	90 Luminaires	SPTE860DS SPTE870DS
SPECTO-XT	GA69	GLOBAL TRAC PRO	Open Area	220-240V AC 50/60 Hz	90 Luminaires	SPTA860XT SPTA870XT
			Standard	220-240V AC 50/60 Hz	90 Luminaires	SPTE860XT SPTE870XT

WARNING



Do not stare at operating lamp. It may be harmful to the eyes.

LUMINAIRE DIMENSIONS

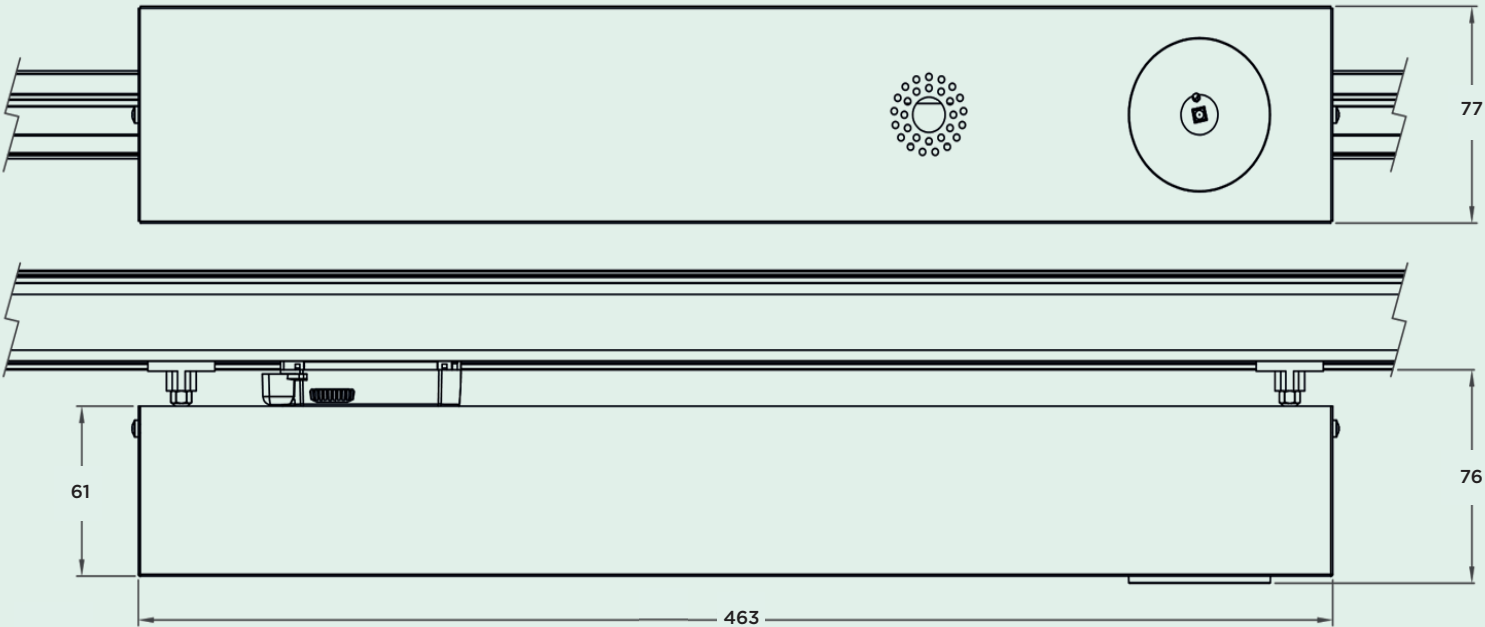

IMPORTANT-SAFETY

Before carrying out any servicing on this luminaire, ensure that the mains supply is fully isolated. Disconnect luminaire before insulation testing of the installation.

## INSTALLATION METHOD

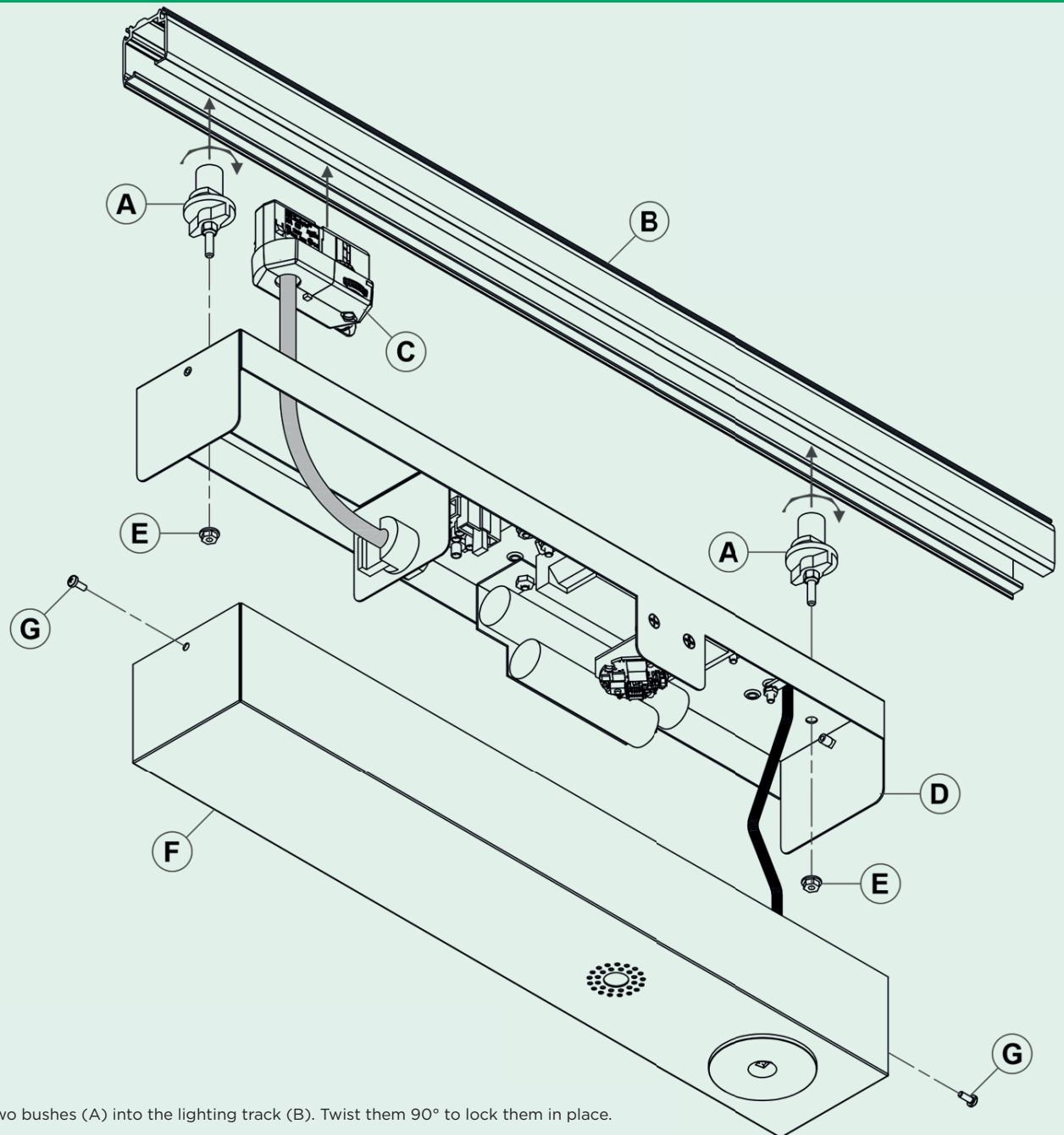

- 1) Push the two bushes (A) into the lighting track (B). Twist them 90° to lock them in place.
- 2) Set the circuit selector switch, on the track adaptor (C), to the common permanent (un-switched) live feed that has been chosen for the use with the emergency lighting. This feed must come from the same local sub-circuit as the local mains lighting.
- 3) Push the track adaptor (C) into the lighting track, and lock it in place with the locking lever or levers.
- 4) Push the luminaire gear-tray (D), onto the studs of the bushes (A), and fix the gear-tray in place with two M4 nuts (E).
- 5) Connect the battery only when the electrical installation has been completed, and a stable, permanent mains supply is assured. Repeated switching of mains power can cause damage to the battery.
- 6) Secure cover (F) in place with two M3 screws (G).

LED STATUS INDICATION	
Operation	Led Status
Normal mode	Green LED- ON
Commissioning	Green LED- ON
Function test	Green LED- Fast Flash
Duration test	Green LED- Slow flash
Lamp fault/open circuit/short circuit	Red LED - ON
Battery fault	Red LED - Slow flash
Charge fault/Circuit fault	Red LED - Fast flash
Emergency mode	LED OFF
Identification	Red/Green LED - Slow flash

FAULT RECTIFICATION SEQUENCE			
1.Fault Identification	Slow Red Flash = Battery Fault	Permanent Red = Lamp Fault	Charge Fault
2. Take Remedial Action	Check Lamp/ Replace Lamp	Check Battery/ Replace Battery	Check Module/ Replace Module
3. Reset Unit/ Check Status	Switch Luminaire unswitched mains off / on For Specto-XT use the Specto-XT Programmer to check status of luminaire.		
4. Automatic Reset	Philip Payne AutoTest automatically resets the module to confirm rectification of fault. The device then reverts to standby mode if the fault has been cleared or returns to fault indication if fault persists. For Specto-XT use the Specto-XT Programmer to initiate function/duration test. The luminaire will pend the test until the battery is sufficiently charged. The test status can be retrieved using the Specto-XT Programmer (please leave at least 60 seconds between test initiation and reading status).		

IMPORTANT

To prevent lamp damage and false triggering of fault status please note the following :-

- Ensure LED's are connected correctly to the luminaire prior to applying power.
- Do not interrupt unswitched supply during self-commissioning period.
- Please allow 51 hours for charge, discharge, charge cycle.

Fitting Reference:			Installation Date:				Location:			
MONTH	TEST	EXAMPLE	1ST YEAR	2ND YEAR	3RD YEAR	4TH YEAR	5TH YEAR	6TH YEAR	7TH YEAR	8TH YEAR
	1. Funtional	PASSED								
	2. Funtional	PASSED								
	3. Funtional	PASSED								
	4. Funtional	PASSED								
	5. Funtional	PASSED								
	6. Funtional	PASSED								
	7. Funtional	FAILED - REPLACED LAMP HEAD								
	8. Funtional	PASSED								
	9. Funtional	PASSED								
	10. Funtional	FAILED - REPLACED BATTERY								
	11. Funtional	PASSED								
	12. 3-Hour Duration	PASSED								

Each month, or more frequently if a fault is identified, we recommend the installation is checked for status of L.E.D.'s. Corrective action if necessary should be taken and recorded on the above form.

Follow good practice as laid down in relevant legislation such as BS 5266.

**EMERGENCY LIGHTING IS THERE TO SAVE LIVES**

TO RESET AFTER A FAULT - SWITCH LUMINAIRE UNSWITCHED  
MAINS OFF / ON.  
SLOW RED LED FLASHING = BATTERY FAULT  
PERMANENT RED LED = LAMP FAULT

## CLEANING INSTRUCTIONS



## INFORMATION

**Operation and Maintenance**

Continual operation at mains voltages in excess of the rated voltage will reduce LED and expected gear life.

This luminaire uses plastic components in its construction and when installed in environments containing chemicals, degradation may occur.

Operation outside intended / stated parameters may cause a hazard, and in an extreme case, for example water ingress to electronic circuits, may cause a fire.

Please contact our Technical Department for advice.

**Modifications**

Philip Payne products should not be modified.

Any modification may render the product unsafe and will invalidate any Safety/Approval marks.

Philip Payne will not accept any responsibility for any modified products or for any damage caused as a result of their modification.

**Monthly and Annual Tests**

Monthly and Annual tests should be carried out in accordance with BS EN 50172:2004, 7.2.

Testing can be carried out by using a sub circuit isolator or by switching off the lighting circuit at the circuit breaker (not for AutoTest or DALI versions).

Battery pack shall be replaced if the specified 3 hour duration is not met.

For replacement battery pack contact Philip Payne Ltd.

The light source contained in this luminaire shall only be replaced by the manufacturer or his service agent or a similar qualified person.



Philip Payne Ltd, Thornhill House, Thornhill Road, Solihull, B91 2HB  
+44 (0)121 705 2384 | mail@philippayne.co.uk | www.philippayne.co.uk

