

# TRACK SPRITE EMERGENCY DOWNLIGHTER

CLASS 1 IP20



PART NUMBER	LENS	NORDIC ALUMINIUM TRACK ADAPTOR	FOR USE WITH NORDIC ALUMINIUM TRACK TYPE	GEAR	OPERATION	APPROX. WEIGHT	SUPPLY VOLTAGE	MAXIMUM LUMINAIRES ON A TYPE B, 10A CIRCUIT BREAKER. INSTALLATION Ø 1.5mm <sup>2</sup>
SPTA860DS	OPEN AREA	GAC69	GLOBAL TRAC PULSE	DALI	NON-MAINTAINED	1.5 KG	220-240V AC 50/60Hz	90 LUMINAIRES
SPTA860LN	OPEN AREA							
SPTA860XT	OPEN AREA	GA69	GLOBAL TRAC PRO	SPECTO XT				
SPTA870DS	OPEN AREA							
SPTA870LN	OPEN AREA	GA69	GLOBAL TRAC PRO	BASIC				
SPTA870XT	OPEN AREA							
SPTA860DS	STANDARD	GAC69	GLOBAL TRAC PULSE	DALI				
SPTA860LN	STANDARD							
SPTA860XT	STANDARD	GA69	GLOBAL TRAC PRO	SPECTO XT				
SPTA870DS	STANDARD							
SPTA870LN	STANDARD	GA69	GLOBAL TRAC PRO	BASIC				
SPTA870XT	STANDARD							

## DIMENSIONS

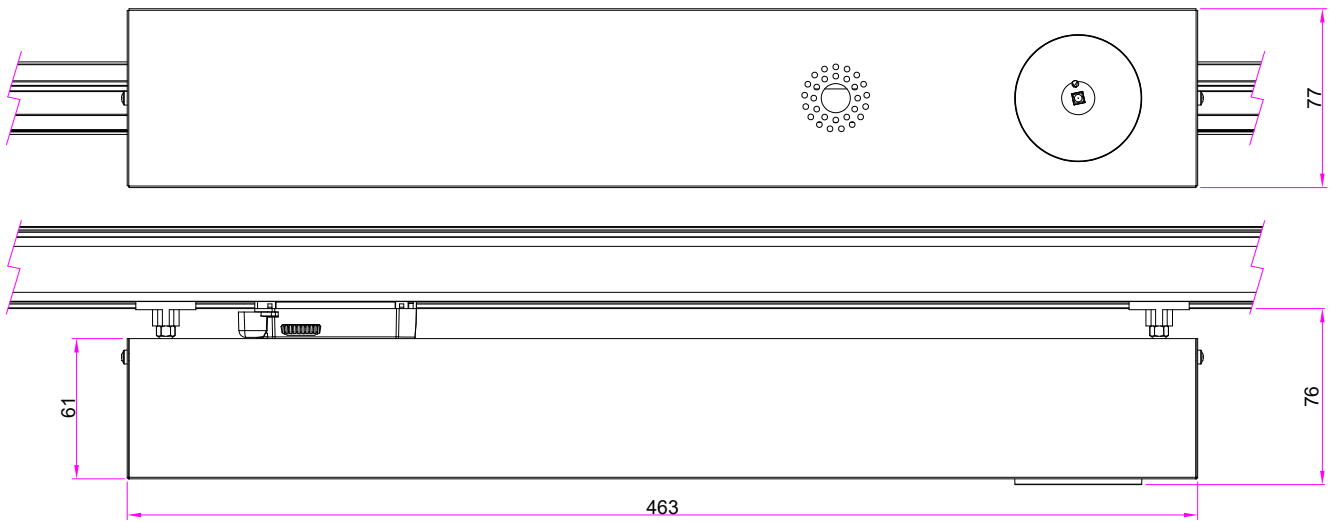

## CLEANING INSTRUCTIONS

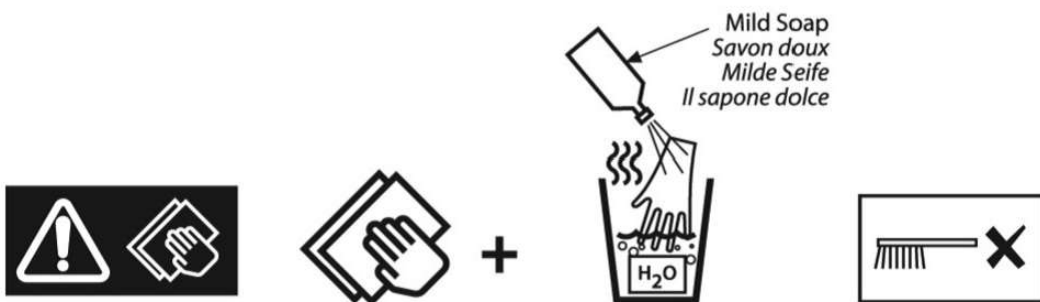

### Operation and Maintenance

Continual operation at mains voltages in excess of the rated voltage will reduce LED and expected gear life. This luminaire uses plastic components in its construction and when installed in environments containing chemicals, degradation may occur. Please contact our Technical Department for advice.

### Modifications

Philip Payne products should not be modified. Any modification may render the product unsafe and will invalidate any Safety/Approval marks. Philip Payne will not accept any responsibility for any modified products or for any damage caused as a result of their modification.

### Monthly and Annual Tests

Monthly and Annual tests should be carried out in accordance with BS EN 50172:2004, 7.2. Testing can be carried out by using a sub circuit isolator or by switching off the lighting circuit at the circuit breaker (not for AutoTest or DALI versions). Battery pack shall be replaced if the specified 3 hour duration is not met. For replacement battery pack contact Philip Payne Ltd. The light source contained in this luminaire shall only be replaced by the manufacturer or his service agent or a similar qualified person.

## INSTALLATION INSTRUCTIONS

## WARNING

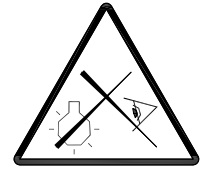

**DO NOT STARE AT OPERATING LAMP.  
IT MAY BE HARMFUL TO THE EYES.**

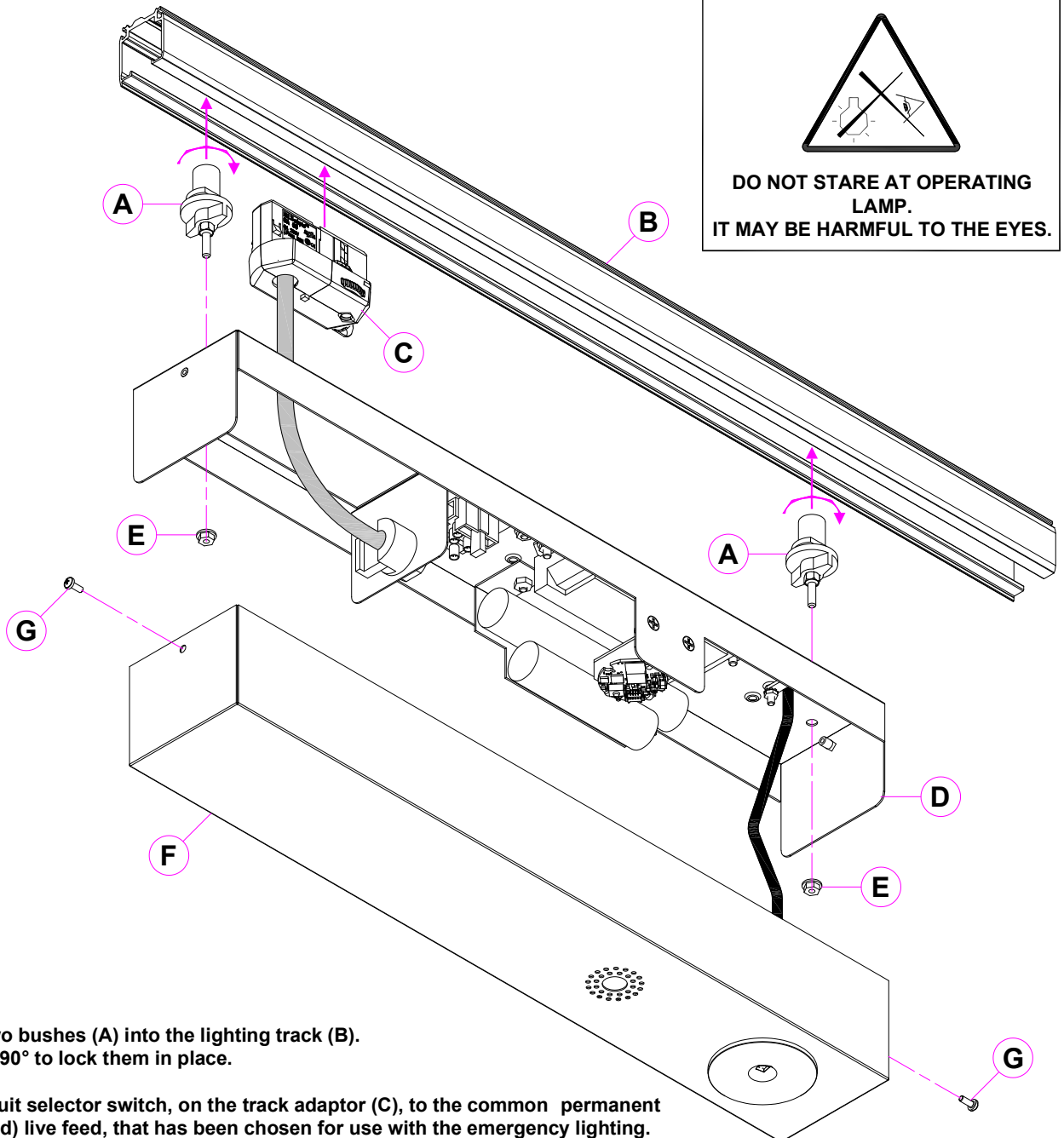

1. Push the two bushes (A) into the lighting track (B). Twist them 90° to lock them in place.
2. Set the circuit selector switch, on the track adaptor (C), to the common permanent (un-switched) live feed, that has been chosen for use with the emergency lighting. This feed must come from the same local sub-circuit as the local mains lighting.
3. Push the track adaptor (C) into the lighting track, and lock it in place with the locking lever or levers.
4. Push the luminaire gear-tray (D), onto the studs of the bushes (A), and fix the gear-tray in place with two M4 nuts (E).
5. Connect the battery only when the electrical installation has been completed, and a stable, permanent mains supply is assured. Repeated switching of mains power can cause damage to the battery.
6. Secure cover (F) in place with two M3 screws (G).

### IMPORTANT SAFETY:-

**BEFORE CARRYING OUT ANY SERVICING ON THIS LUMINAIRE, ENSURE THAT THE MAINS SUPPLY IS FULLY ISOLATED.**

**NOTICE TO CONTRACTOR: PLEASE PASS THIS LEAFLET TO THE END USER.**



### Philip Payne Ltd

A SUBSIDIARY OF F.W. THORPE PLC  
Thornhill Road, Solihull, B91 2HB, England.  
Tel: 0121 705 2384  
Fax: 0121 711 2469  
e-mail: mail@philippayne.co.uk  
Website: <http://www.philippayne.co.uk>  
Philip Payne Ltd registered in England No. 1361523



ISO9001  
FM55077



21LFT105\_3