

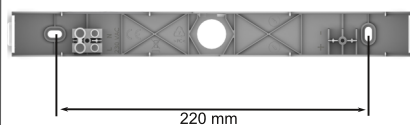

Mounting & Service Manual Go! Ceiling

Philip Payne

MOUNTING



1 Determine cable input opening. Place a grommet or cable gland. Mount the mounting box. Connect the wires according to the wiring diagram.

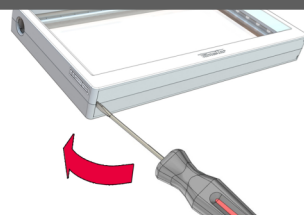

2 Push a screwdriver into the slot provided to lever open the service hatch.



3 Insert the pictogram as shown in the picture above.

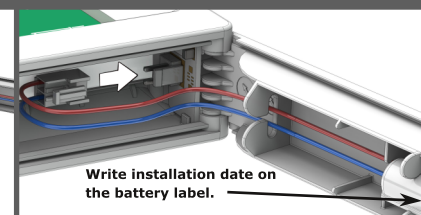

4 Put the battery connector in position. Push the battery wires downwards. Close the service hatch.



5 Mount the lightunit on the base plate.

WIRINGDIAGRAM

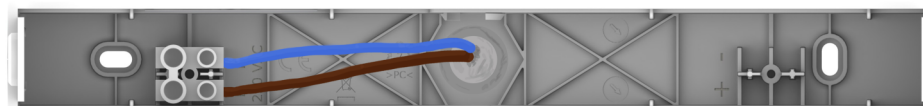

SPECTO XT

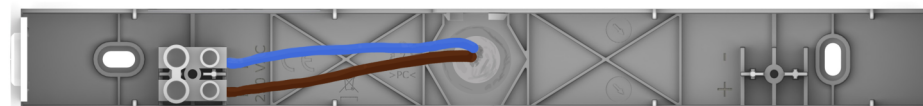

DALI



TESTING

STATUS INDICATION:

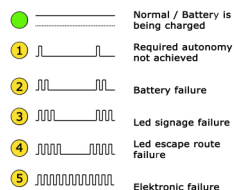

ATS CYCLE:

Automatic

Test

System

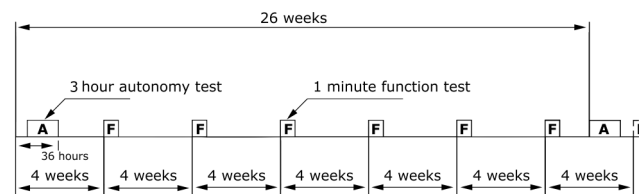

SERVICE



1 Monthly and annual tests should be carried out in accordance with BS EN 50172:2004, 7.2. Clean the luminaire every year.



2 Remove the lightunit from the base plate by: (1) pushing both clickers on the side, (2) pulling the lightunit downwards.

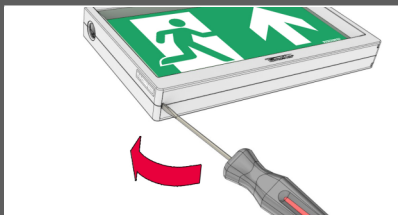

3 Push a screwdriver into the slot provided to lever open the service hatch.

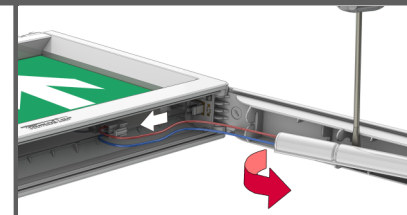

4 Change the battery if required autonomy isn't achieved. Remove the battery with a screwdriver. Write the installation date on the battery label of the new installed battery.



Go! Ceiling

SPECIFICATION

Type	Voltage	Power consumption*	Current	Power factor
DALI	230V / 50 Hz	2 W	17 mA	0,6
SPECTO XT	230V / 50 Hz	2 W	17 mA	0,6

*maximum values at switched-on light source and not fully charged battery

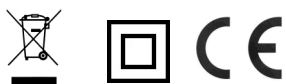

Mounting	Installation on normal flammable surfaces.
Temperature range	+5 °C till +40 °C
Dimensions	See www.philippayne.co.uk
Autonomy	3 hours
Light source	Led
ATS	Automatic Test System (IEC 62034)
Battery	3,6V 1,1 Ah NiMh (AA cell)
Protection rate	IP40 (IP20 with track adaptor)
Insulation class	Class II, double insulated (no ground connection needed).
Material	Polycarbonate (PC)

Warranty, accessories and spacing tables and further information see www.philippayne.co.uk