

300CBH



- IP20**
- 5** WARRANTY
- 26m**
- 1.5** KG
- 230v**
- DALI**
- NM/MM**
- 1W**



- EN 60598-1
- EN60598-2-22
- EN55015
- EN61547
- EN61000-3-2

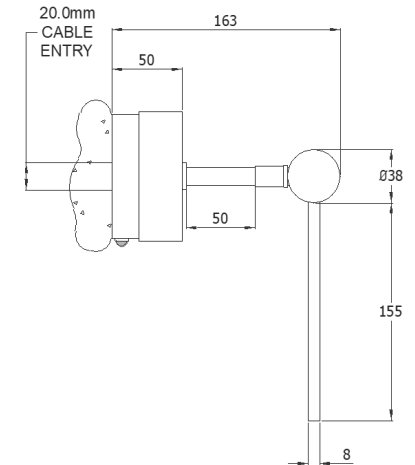

EXAMPLE PRODUCT CODE		300	CBH	O5	LM	W
FAMILY	CLASSIC CYLINDER	300				
PRODUCT	SQUARE COVER, HORIZONTAL CYLINDER	CBH				
ROD LENGTH	50mm	O5				
CONTROL GEAR	MAINS/CENTRAL BATTERY*	LA				
	MAINS/CENTRAL BATTERY DALI*	DA				
	MAINTAINED SELF-CONTAINED	LM				
	MAINTAINED AUTOTEST	YL				
	MAINTAINED DALI	DL				
	MAINTAINED SPECTO-XT	XT				
COLOUR	POLISHED BRASS	B				
	POLISHED CHROME	C				
	BMA	D				
	GREY	G				
	BLACK	K				
	SATIN CHROME	R				
	PENNY BRONZE	V				
	WHITE	W				

For more information on colours, please go to the **Finishes Page**. For more information on Legends, please go to the **Legends Page**.

*For input voltages please refer to our installation leaflets.