

• Installation Instructions •

Reference No.	Mounting Style
LUL 300 SW LA	Surface Wall

Surface Wall Mounted

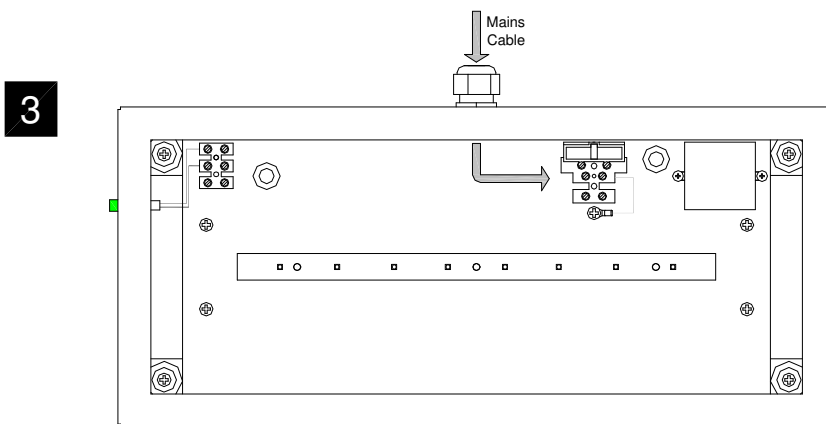
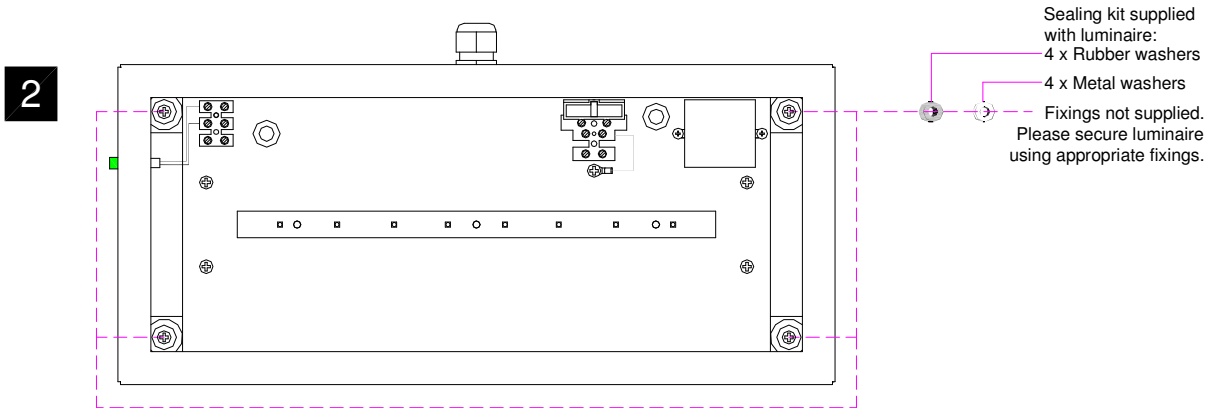
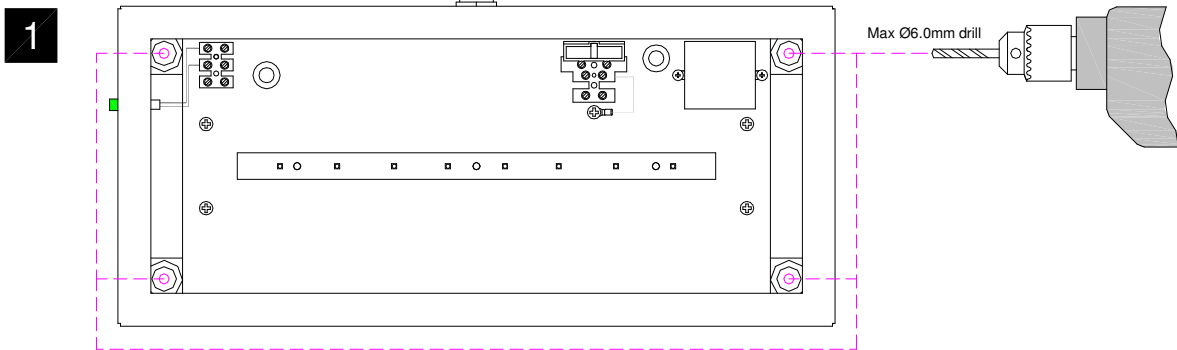

Mains Connections

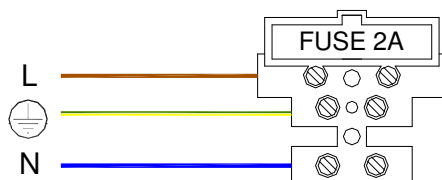

Reference No.	Mounting Style
LUL 300 SW LM	Surface Wall

Surface Wall Mounted

1

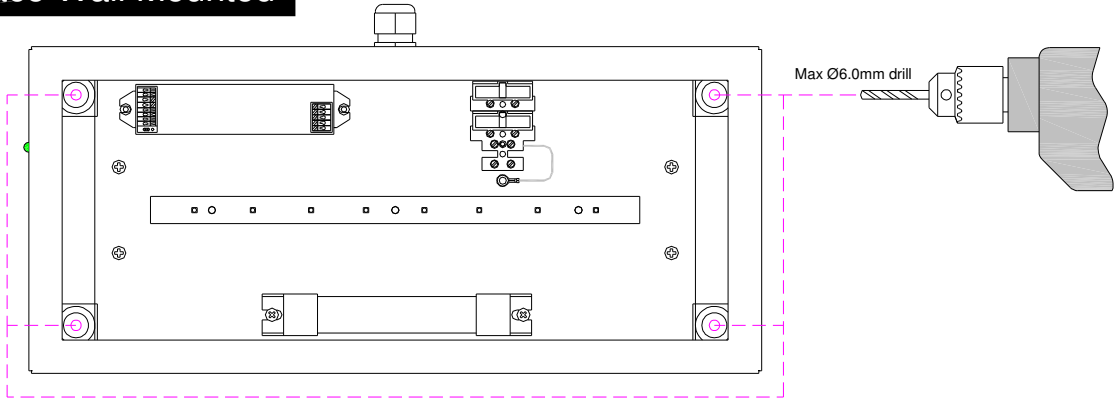

2

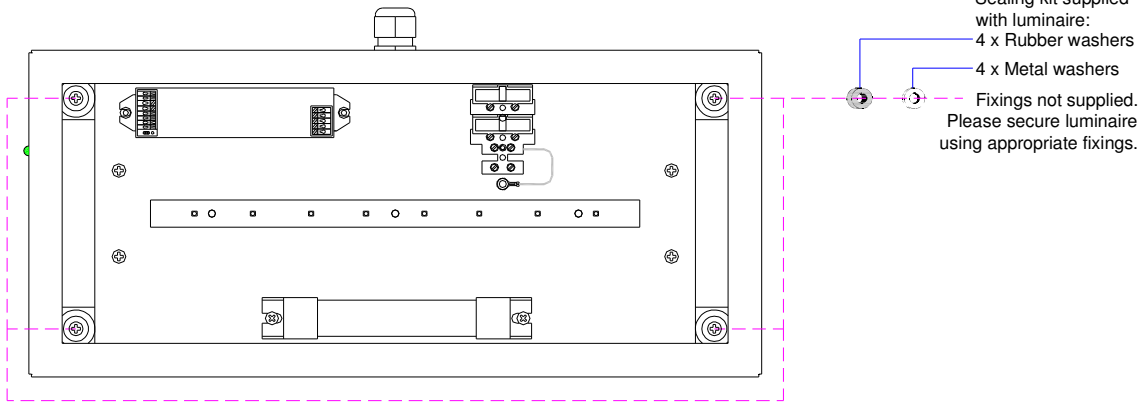

3

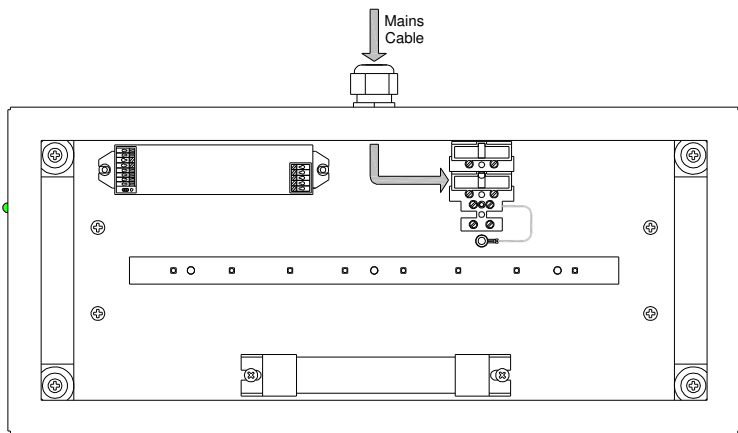

Mains Connections

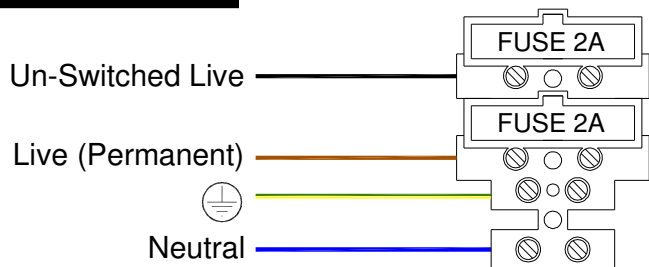

Reference No.	Mounting Style
LUL 300 SW TL	Surface Wall
LUL 300 US TL	Uni Strut

1a. Surface Wall Mounted

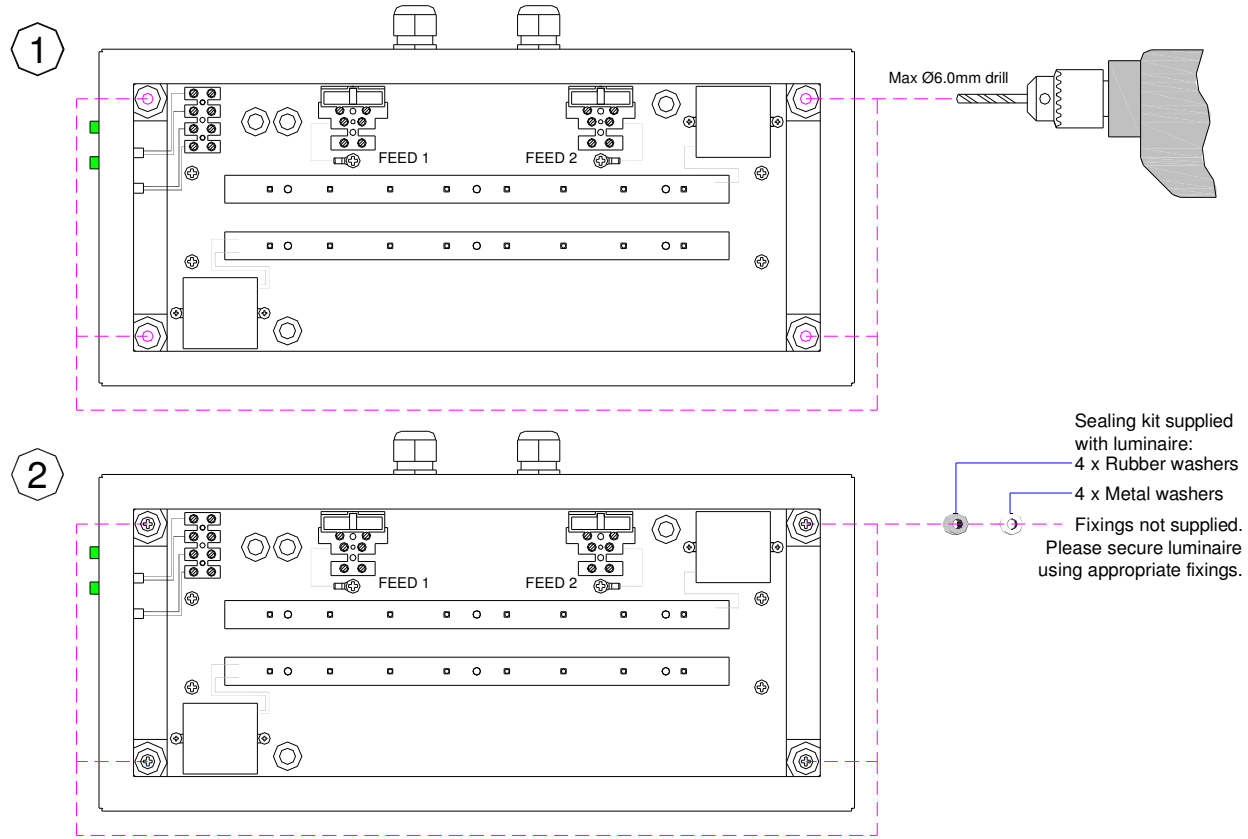

1b. Unistrut Mounted

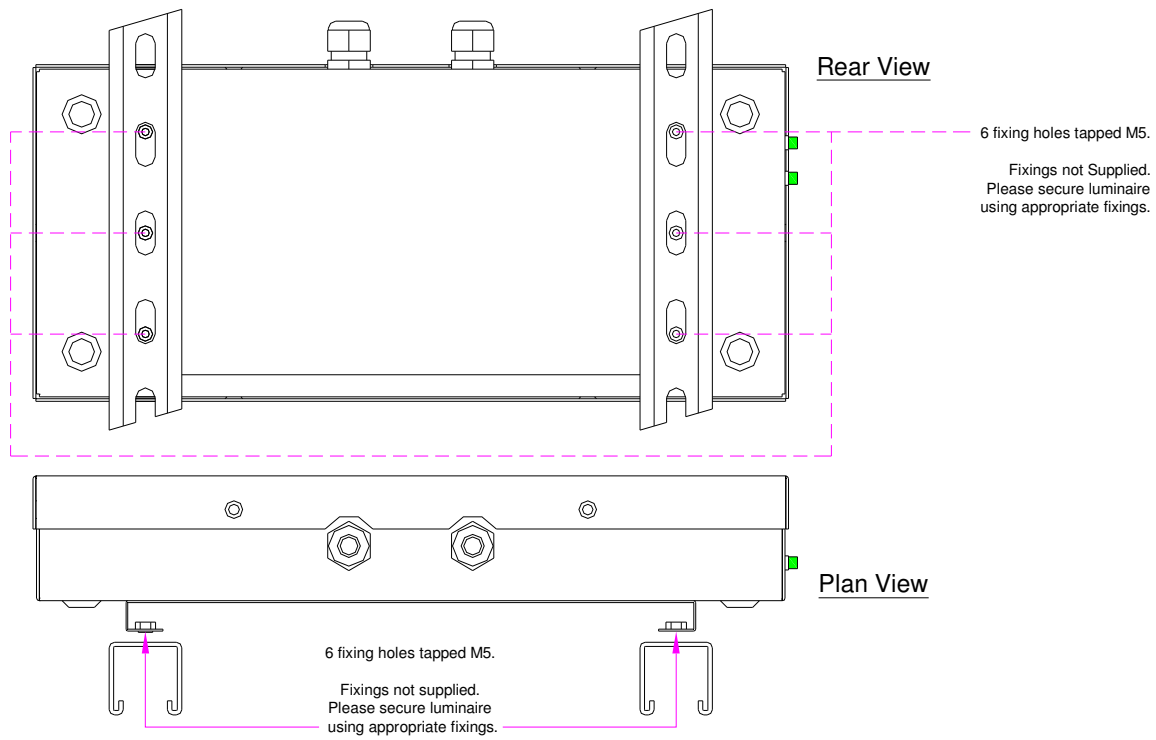

2.

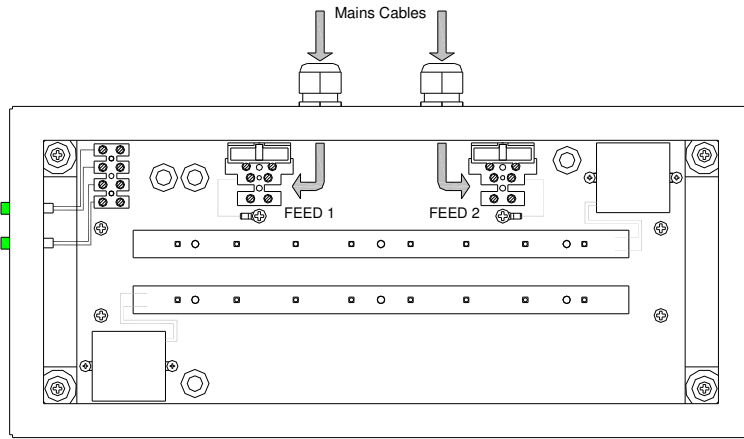

Mains Connections

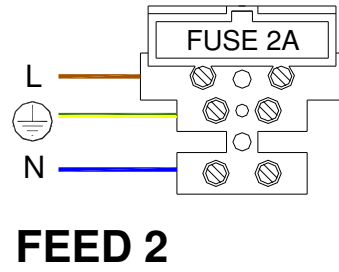
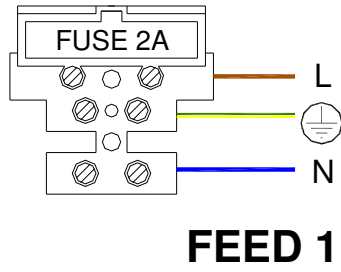

Cover / Legend Removal

A

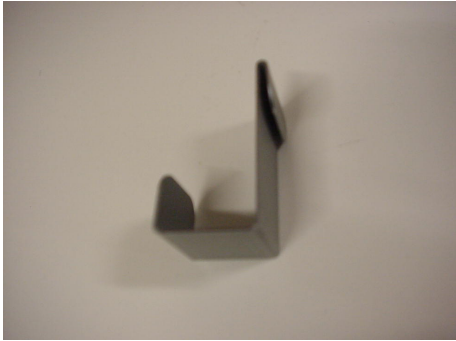

Use Key Provided.

B

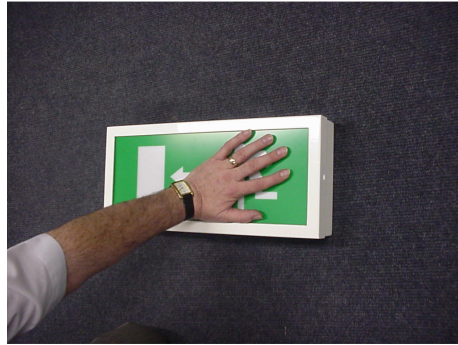

Secure Legend panel with hand.

C



Locate Tool under edge of frame.

D



Gently pull back on tool to remove frame, leaving legend free.

Lift legend to access gear tray.

Care Instructions



Mild Soap
Savon doux
Milde Seife
Il sapone dolce



Important-Safety

Before carrying out any servicing on this luminaire, ensure that the mains supply is fully isolated.
Disconnect luminaire before insulation testing of the installation.

Modifications

Philip Payne products should not be modified.
Any modification may render the product unsafe and will invalidate any Safety/Approval marks.
Philip Payne will not accept responsibility for any modified products or for any damage caused as a result of their modification.

Monthly and Annual Tests

Monthly and Annual tests should be carried out in accordance with: BS EN 50172:2004, 7.2.
For replacement LED strip contact Philip Payne Ltd.

Operation and Maintenance

Failed LED strips should be replaced promptly or the circuit switched off to avoid possible damage to control gear.
Continual operation at mains voltages in excess of the rated voltage will reduce LED and expected gear life.
The LUL300 uses plastic components in its construction and when installed in environments containing chemicals, degradation may occur.
Please contact our Technical Department for advice.

Philip Payne Ltd

A SUBSIDIARY OF F.W. THORPE PLC
Thornhill Road, Lode Lane, Solihull, B91 2HB, England.

Tel: 0121 705 2384
Fax: 0121 711 2469

E-mail: mail@philippayne.co.uk
Website: <http://www.philippayne.co.uk>

Philip Payne Ltd registered in England No. 1361523



ISO 9001
FM55077



21LFT066_1