

# 2-Ni LED Twin Spot

## 2 x 3.5W LED Emergency Luminaire

CLASS 1 IP65



	LAMP	CATALOGUE NUMBER	TYPE	APPROX. KG
Emergency	3.5W LED 29°	AVTN296LNIPG	Non-Maintained operation	1.5
	3.5W LED 63°	AVTN636LNIPG		1.5
AutoTest	3.5W LED 29°	AVTN296YSIPG	Non-Maintained operation	1.5
	3.5W LED 63°	AVTN636YSIPG		1.5
DALI AutoTest	3.5W LED 29°	AVTN296DSIPG	Non-Maintained operation	1.5
	3.5W LED 63°	AVTN636DSIPG		1.5

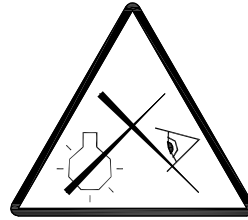

Do not stare at operating lamp.  
It may be harmful to the eyes.

### Dimensions

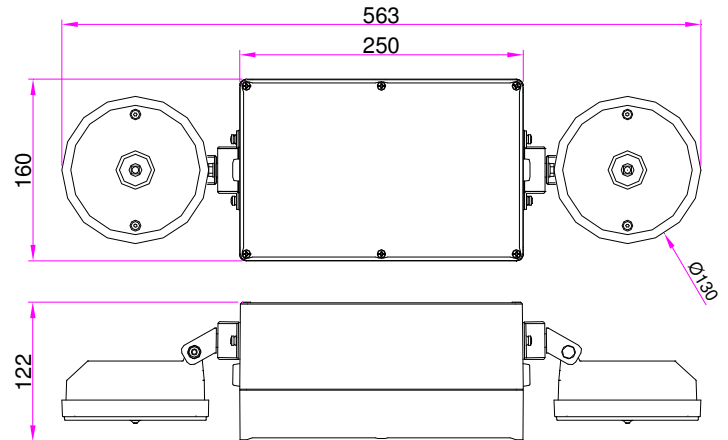

1

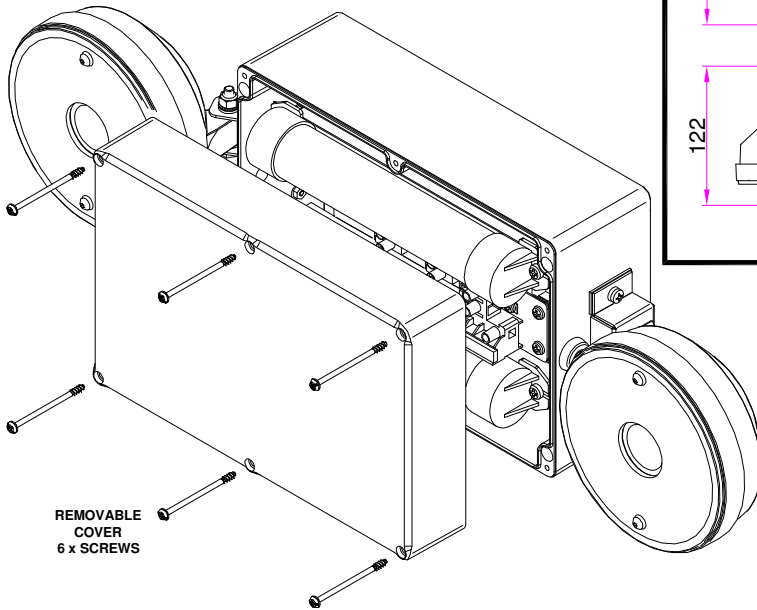

2

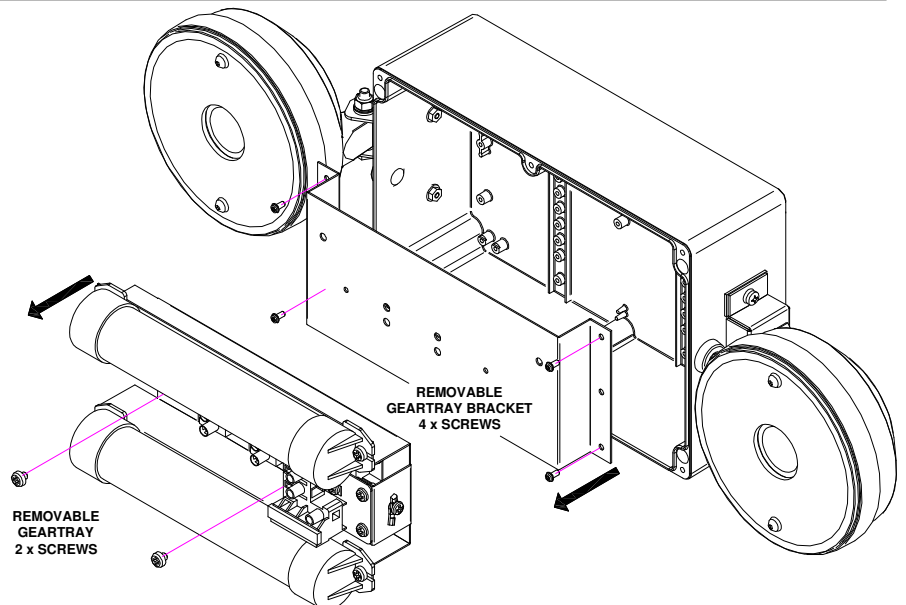

3a

Rear entry option  
with IP65 glands

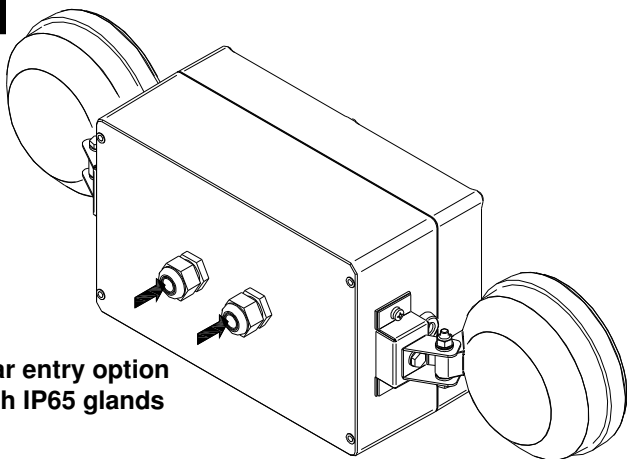

3a

Side entry option with  
IP65 glands

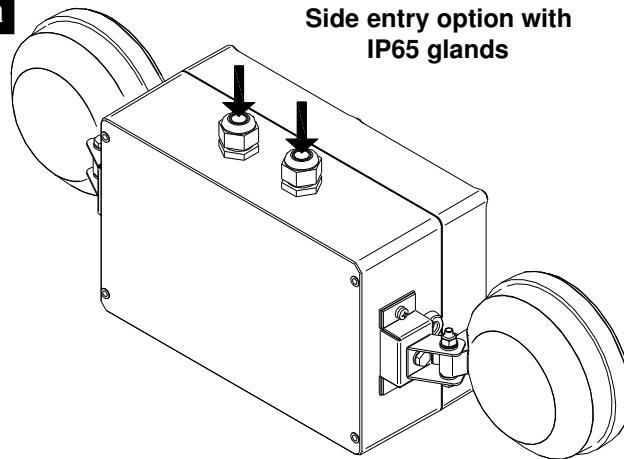

## Connections

Emergency  
and AutoTest  
versions

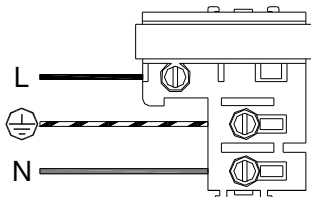

DALI  
AutoTest  
version

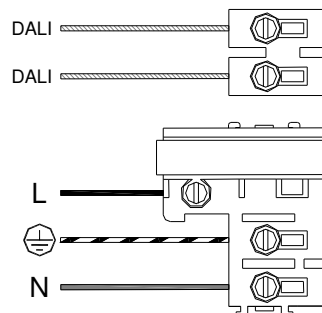

## Cleaning Instructions

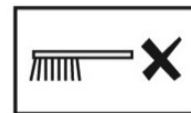

## Operation and Maintenance

Failed lamps/light sources should be replaced promptly or the circuit switched off to avoid possible damage to control gear.

Continual operation at mains voltages in excess of the rated voltage will reduce LED and expected gear life.

This luminaire uses plastic components in its construction and when installed in environments containing chemicals, degradation may occur.

Please contact our Technical Department for advice.

### Modifications

Philip Payne products should not be modified.

Any modification may render the product unsafe and will invalidate any Safety/Approval marks.

Philip Payne will not accept any responsibility for any modified products or for any damage caused as a result of their modification.

### Monthly and Annual Tests

Monthly and Annual tests should be carried out in accordance with BS EN 50172:2004, 7.2.

Testing can be carried out by using a sub circuit isolator or by switching off the lighting circuit at the circuit breaker (not for AutoTest or DALI versions).

Battery pack shall be replaced if the specified 3 hour duration is not met.

For replacement battery pack contact Philip Payne Ltd.

**The light source (LED's) contained in this luminaire shall only be replaced by the manufacturer or his service agent or a similar qualified person.**

## Important-Safety

**Before carrying out any servicing on this luminaire, ensure that the mains supply is fully isolated.**

**Disconnect luminaire before insulation testing of the installation.**

NOTICE TO CONTRACTOR - PLEASE PASS THIS LEAFLET TO THE END-USER.



### Philip Payne Ltd

A SUBSIDIARY OF F.W. THORPE PLC  
Thornhill Road, Solihull, B91 2HB, England.

Tel: 0121 705 2384  
Fax: 0121 711 2469  
e-mail: mail@philippayne.co.uk  
Website: http://www.philippayne.co.uk  
Philip Payne Ltd registered in England No. 1361523



ISO9001  
FM55077



21LFT046\_2